

(108th claim)
(Statement and Notice) Con 226

[Note: in English]

William Ross gives notice to J. L. Donaldson Esq. That the claims titled to the following tract of Land viz. A tract of 420 a. of land situate in the Dist. of Cape Girardeau granted to him by virtue of a Concession from Trudeau bearing date the 5 Jan y 1798.

[Note: in French]

(Concession)

A Don Louis Lorimier, commandant du poste du Cape Girardeau, William Ross ci-devant habitant de la Caroline du Nord désirant se fixer sur cette rive, à l'honneur de vous prier de vouloir lui accorder une terre de 420 a. en superficie située sur le bord du fleuve au dessus du Cap à la Cruche et joignant la terre du Sr Pierre Godair, laquelle terre il s'engage à établir et mettre en valeur sous le terme prescrit par la loy, grâce que le suppliant espère de v. (?) justice au cap Girardeau le 15 7bre 1797. William Ross. Cap Girardeau le 17 7bre 1797. Soit passé à Mr le Lieutenant Gur (?) en le prévenant que la terre demandée appartient au domaine de Sa Majesté et que la concession d'icelle ne porte préjudice à personne en considération de quoi j'ai permis au suppliant l'établissement provisoire de ladite terre jusqu'à ce qu'il vous plaise d'ordonner qu'il en soit mis en possession par l'arpenteur du roy. Signé L. Lorimier.

[Note: in Spanish]

San Luis de los Illinois 5 Enero de 1798.
Constandome
por el informe del Commandante del Cabo Girardeau Don L. Lorimier que la tierra que se solicita esta vacante y no perjudicia a los circonvencinos, el Aga Don Antonion Soulard pondra el interesado en posesion de ella y verbalizera su ... a continuacion para que serva a solicitar la concession del Señor

Gobernador General el que queda informado
que el sugeto merece la gracia que solicita. Signed Zenon Trudeau.

Nota : los terminos puestodes en todos los angulos y los
... de vinte arpentos de distancia entre ellos y todos ... los arboles
de los limites estan señalados. Libro A p° 3, n°78
Don Antonio Soular Agor ... de los ...
de la Certifico que el 7 de Diciembre del año proximo pasado en
virtud del decreto
que entecede del Señor Don Zenon Trudeau, ... de
Gobernador de estos establecimientos me he tranferido a la tierra de
Guillermo Ross para tomar en elle las medidas de agricultura ; arreladas
a su pedimiento de 200 ... de 420a. Planos de superficie, vuyas medidas
se han tomado en presencia
del propietario y de los vecinos linderos con la medida de Paris de 18
pies de largo segun constumbre adopta-
da en esta provincia de la Luisiana, y sin tocar a lo que puede dat de si la
variacion de la abuja (?) que es de 7gs 30m E
como consta del plano figurativo que entecede, cuya tierra se halla
situada a 6 millas al Sur Sur Este del establecimiento
de Cabo Girardeau, Lindano por el .. con tierra de Pedro Godain por los
del Sur y Oste con las tierras vacantes del
... .. y por el Este con el rio Mississipy y para que conste el
presentecon el plano figurativo que precede en el qual se indican las
dimiensiones y limites naturales y artificiales de dicha
tierra. En San Luis de Illinois, 5 de Enero de 1800. Signed Antonio Soulard

Translation :

(108th claim)
(Statement and Notice) Con 226

[Note: in English]

William Ross gives notice to J. L. Donaldson Esq. That the claims titled to the following tract of Land vir. A tract of 420 a. of land situate in the Dist. of Cape Girardeau granted to him by virtue of a Concession from Trudeau bearing date the 5 Jan & 1798.

[Note: in French]

(Concession)

To Don Louis Lorimier, commandant of the post of Cape Girardeau, William Ross, formerly a resident of North Carolina, wishing to settle on this bank, has the honor of requesting that you grant him a tract of land of 420 arpents in area, situated on the bank of the river above Cap à la Cruche and adjoining the land of Mr. Pierre Godair. Said land he undertakes to establish and cultivate within the term prescribed by law, a favor which the petitioner hopes from your justice. At Cape Girardeau, September 15, 1797. William Ross.

Cape Girardeau, September 17, 1797. Let this be forwarded to Mr. the Lieutenant Governor, informing him that the land requested belongs to the domain of His Majesty and that its concession will prejudice no one; in consideration whereof I have permitted the petitioner the provisional establishment of said land until it shall please you to order that he be put in possession thereof by the King's surveyor.

Signed: L. Lorimier.

[Note: in Spanish]

St. Louis of the Illinois, January 5, 1798. From the report of the Commandant of Cape Girardeau, Don L. Lorimier, it appearing to me that the land requested is vacant and does not prejudice the neighboring inhabitants, Don Antonio Soulard, Surveyor, shall place the interested

party in possession thereof and shall record the proceedings hereafter so that they may serve in petitioning for the concession from the Governor General, who is informed that the applicant deserves the favor he requests. Signed: Zenon Trudeau.

Note: The boundary markers are placed at all the corners and at intervals of twenty arpents between them, and all the boundary trees are marked. Book A, page 3, no. 78.

I, Don Antonio Soulard, Surveyor of this Province of Louisiana, certify that on the 7th of December of last year, by virtue of the foregoing decree of Don Zenon Trudeau, Lieutenant Governor of these establishments, I went to the land of William Ross to take the agricultural measurements thereof, in accordance with his petition for 200 arpents out of 420 arpents of surface area. These measurements were taken in the presence of the proprietor and of the adjoining neighbors, with the Paris measure of 18 feet in length according to the custom adopted in this Province of Louisiana, and without regard to what may result from the variation of the needle, which is 7 degrees 30 minutes East, as appears from the accompanying survey plat.

The said land is situated six miles south-southeast of the settlement of Cape Girardeau, bounded on the north by the land of Pedro Godair, on the south and west by vacant lands, and on the east by the Mississippi River.

And for the record I have issued the present certificate with the accompanying survey plat, in which are indicated the dimensions and the natural and artificial boundaries of said land. At St. Louis of Illinois, January 5, 1800. Signed: Antonio Soulard.

SUMMARY OF THE DOCUMENT

No date. (September 16, 1805) William Ross gave notice to James L. Donaldson of his Concession and it was recorded by him as the 108th land claim and Concession 206.

September 15, 1797. Don Louis Lorimier receives a request from William Ross to settle the land on the bank of the Mississippi.

September 17, 1797. Lorimier on indicates the request is legal and forwards it to the Lieutenant Governor Zenon Turdeau for approval.

January 5, 1798. Zenon Trudeau approves the request and orders Antonio Soulard to survey the land.

December 7, 1799. Antonio Soulard surveys the land

January 5, 1800. Antonio Soulard presents a certificate for survey

NOTES REGARDING PEOPLE IN THE DOCUMENT AND PROCESSES

The **Registers of Land Titles, Book A**, were recorded by the United States government starting on **September 16, 1805**. I do not see an individual recorded date for William Ross, so this is the best date to utilize of William's claim as confirmed by the United States.

While Spanish rule began in the 1760s, the most documented grants are found from 1790 to 1803. After the 1803 Louisiana Purchase, the U.S. government required these prior claims to be validated, with land boards meeting from 1805–1812 (first Board of Land Commissioners), and again in 1832 (second Board of Land Commissioners), to confirm Spanish and French claims.

On March 2, 1805, President Thomas Jefferson signed into law an "Act for ascertaining and adjusting the titles and claims to land within the Territory of Orleans and the district of Louisiana." Anyone owning a registered warrant or survey prior to October 1, 1800, had to have their claims confirmed by the United States by the Board of Land Commissioners. **James L. Donaldson** served as the **Recorder of Land Titles** on the first Board of Land Commissioners (1805–1812) in the Louisiana Territory, evaluating Spanish land claims. He was appointed to validate, not create, land claims following the 1803 Louisiana Purchase.

Because of complaints by those rejected, a second Board of Land Commissions was formed in 1832.

Don Louis Lorimier established a post in Cape Girardeau. In 1793 Lorimier was appointed Commandant of Cape Girardeau under the Spanish government. He recommended people for land grants, held court, took the census, and maintained the militia for Cape Girardeau. William Ross's petition contains a recommendation from a lower level government official being Louis Lorimier. The lots of Cape Girardeau streets were laid out in 1806, being about ten years after William Ross settled on his land. Cape Girardeau was incorporated in 1808.

Zenon Truedeau served as Upper Louisiana's Lieutenant Governor from July 1792 to 1799, commanding in St. Louis under the Spanish government. Truedeau of French ancestry was born in New Orleans in 1748. Lt. Gov. Zenon Truedeau approved the Concession of William Ross.

Spanish land grants in Missouri (then Upper Louisiana Territory) required applicants to pledge loyalty to the Spanish King, adopt the Catholic faith, and, in many cases, settle and cultivate the land to establish actual possession, often with a formal survey completed. Key requirements included obtaining permission from a local commandant, settling the land, which means building a house, before a specific deadline, and having the survey recorded. It is worthy to mention that William Ross was Baptist.

I note that there are 3 months and 19 days between Lorimier's recommendation and Truedeau's approval. There is 1 year, 11 months, 3 days between Truedeau's approval and the date of the survey.

Many grants were documented by **Surveyor Antoine Pierre Soulard** between 1798 and 1806. **Soulard** (1766-1825), who was French, created the Registre d'Arpentage which translates to "register of land surveying." This register is commonly known as the "**Soulard Surveys**," which contain valuable hand drawn plats and maps, and brief descriptions of the boundaries in relation to towns or other landmarks such as rivers, lakes, stones, and trees.

This Register is found in the Missouri Digital Heritage (<https://mdh.contentdm.oclc.org/digital/collection/regdarpen>) collection and William Ross is not listed. I am not sure why it is not on this website with this collection. This Register by Soulard is not the same as the Register of Land Titles.

Soulard located grants by the French government and the Spanish government to certified them. Soulard created the surveys under the rule of the Spanish government, but wrote surveys in his native French language. After the Louisiana Purchase in 1803, Soulard was appointed in the same position as surveyor by the United States and began writing in English. It is interesting that William Ross's Survey is written in Spanish.

When Soulard was replaced in May 1806, the surveys ended although the project was not finished with not all land grants recorded in Soulard's Surveys. There are 710 surveys in the Soulard Surveys.

Other land grants can be found in the Papers of Original Claimants or in the books of the Board of Land Commissioners.

The French used a measuring system of "arpents," (6/7th of an acre), but English used "metes and bounds."

Source of original document:

<https://www.familysearch.org/en/search/catalog/45759>

Book A. Recorder of Land Titles

Records of Land Titles begun and kept at St Louis
on the 16th day of September in the year of our
Lord 1805 by James I Donaldson Recorder of
Land Titles of the Territory of Louisiana, un-
der the Provisions of an act of Congress of the
United States, entitled "an act for ascertaining
the titles and claims to Lands within the
Territory of Orleans, and district of Louisiana"

This is the first page of the Register of Land Titles, Book A, showing the date of September 16, 1805.

Rocque, Manual - Book D, p. 9

Rodney, Martin - Book E, p. 277
Book B, p. 284
Book A, p. 182

Rodney, Thomas - Book B, p. 304

Rodnques, John - Book C, p. 468

Roebuck, Geo. - Book E, p. 128

Rogan, Bernard - Book B, p. 249

Rogan, Michael - Book D, p. 277

Rogers, Ad - Book E, pp. 70, 227

Rogers, Adeston - Book B, p. 286

Rogers, Benj. - Book B, p. 369

Rogers, James - Book B, p. 345

Rogers, John - Book E, p. 207

Rogers, Lewis - Book E, p. 204

Rogers, Robert - Book A, p. 431

Rogers, Ezekiel - Book B, p. 123

Rogue, Augustin - Book D, p. 354

Rohrer, David - Book C, p. 52

Rollins, Seneca - Book C, p. 477

Romine, Christy - Book D, p. 342

Romine, John - Book D, p. 221

Rose, Benj. - Book E, p. 245

Rose, Thomas - Book D, p. 68-73

Rose, Wm. - Book A, p. 197

Roubideaux, Joseph - Book A, pp. 9, 13
Book B, pp. 94, 93

Roudin, Peter - Book D, p. 5

Rouillers, J. B. - Book D, p. 6

Rouquier (?), Genevieve - Book C, p. 267

Rourke, John - Book D, p. 256

Roussell, Peter - Book C, p. 33

Routier, Louis - Book D, p. 238

Rowark, Amos - Book B, p. 347

Rowland, Daniel - Book D, p. 333

Rudde1, George - Book A, p. 358

Rudde1, Abrams - Book A, p. 420

Ruddell, John - Book A, p. 418

Ruggles, Martin - Book B, p. 229
Book E, p. 289

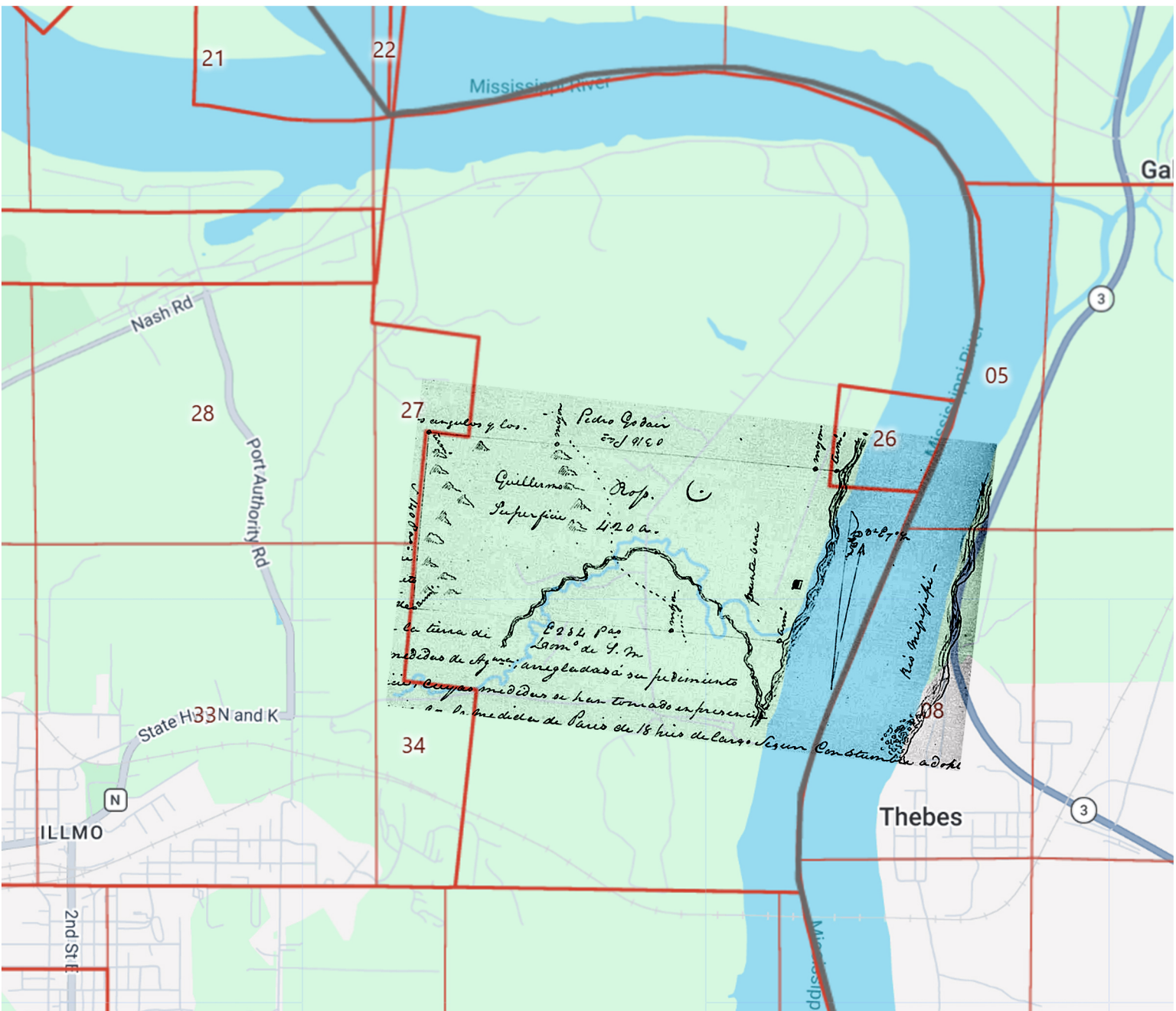

William Ross land
 Overlay of 1797 Survey

Transcription:

No. 78

William Ross

Situé à environ six miles
dans le Sud Sud Est du village du Cap Girardeau.

Les bornes sont de pierre avec témoins.

Le terroir généralement fertile, ...

à l'outil du sentier géomètre. La partie qui avoisine le fleuve est une pointe basse.

Dressé avec Mr le Lieutenant Gouverneur en date du 5 janvier 1798. Arpenté le 7 décembre 1799.

certificat expédié le 3 janvier 1800.

Translation:

No. 78

William Ross

Located approximately six miles
to the south-southeast of the village of Cape Girardeau.

The boundary markers are stone with witness markers.

The land is generally fertile,

according to the surveyor's instrument. The portion bordering the river is a low point of land.

Drawn up with the Lieutenant Governor on January 5, 1798. Surveyed on December 7, 1799.

Certificate issued on January 3, 1800.

Around the hand drawn map:

Along Northern line

P. Godair

At 315 perche (rod or pole, unit of measurement)

In the middle of box

Superficie (Area) 420 arps

Along Southern line

E 284 1er (possibly Section E, Plot 284, 1st part) | Vacant

Along Western line

Jud. 140 1er (Jud. 140 1st part) | Vacant.

31

N^o. 70.
William Ross.

30 1820.

Site à environ six milles
dans le S.E. — du Village du
Cap Perceuse.

Hauteur.



Les Bornes sont de Pierre avec
témoins.

Le terrain généralement fertile, élevé et montagneux
à l'ouest du sentier qui mène à la partie qui avoisine
la Rivière est une pointe basse.

Deuxième de M. le Lieutenant Ross, en date du 3 Janvier 1820.
Signé le 7^e Décembre 1820.
Certificat expédié le 3 Jan^{er} 1800.

No. 70.

William Ross.

32 3/4 miles.

Site à environ six miles
dans le S.E. — du Village du
Cape Girardeau.

facult.

Sur. 140 pi.

316 1/2

Superficie 420. arp.

E. 24 1/2 P.

facult.

Les Bornes sont de Pierre avec
témoins.

Le terrain généralement fertile, élevé et montagneux
à l'ouest du sentier qui traverse la partie qui avoisine
la rivière est une pointe basse.

Deceit de M. le Lieutenant Ross, en date du 3 Janvier 1800.
Signé le 7^e Decembre 1800.
Certificat expédié le 3. Jan^r 1800.

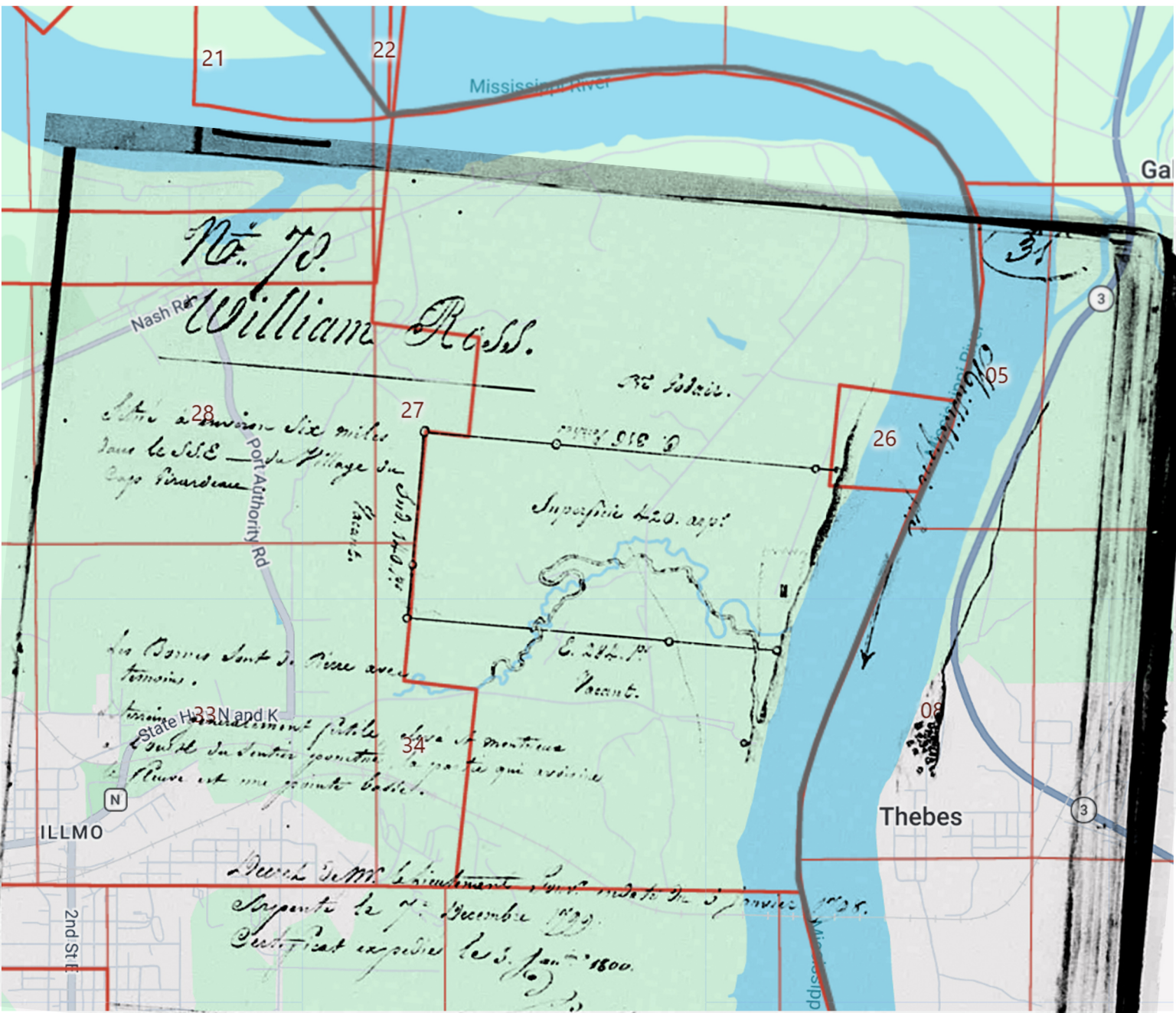

No. 70.
 William Ross.

Étendue environ six miles
 dans le S.E. du Village de
 Cape Girardeau

Superficie de 20. arp.

les bornes sont de Pierre avec
 témoins.

à l'extrémité du terrain qui se trouve
 à l'Est de la route qui traverse
 la Rivière est une pointe basse.

Deuxième de M. le Lieutenant Louis de la Roche le 3 Janvier 1799.
 Signé le 7^e Décembre 1799.
 Publiée en vertu le 5 Jan^r 1800.

William Ross land
 Overlay of 1799 Survey